

# Installation instructions

## FA-AL



## 1. General information

Please check in good time before starting the installation whether the delivered material is complete and free of damage. Any damage or missing components must be reported to MIGUA immediately. Check whether the material and the on-site conditions comply with the technical data on the data sheet. Check the preliminary work of other maintenance groups to ensure that it has been carried out properly and is free of defects.

## 2. Cutting

Start by measuring the required length and saw the joint cover to the appropriate length.

## 3. Marking the plumb line

Draw a perpendicular line with a pencil 63mm from the edge of the joint. For the corner version, mark a perpendicular line 57mm from the wall edge.



## 4. Marking the holes

Place the joint cover on the marked line and transfer the holes of the cover plate to the wall.

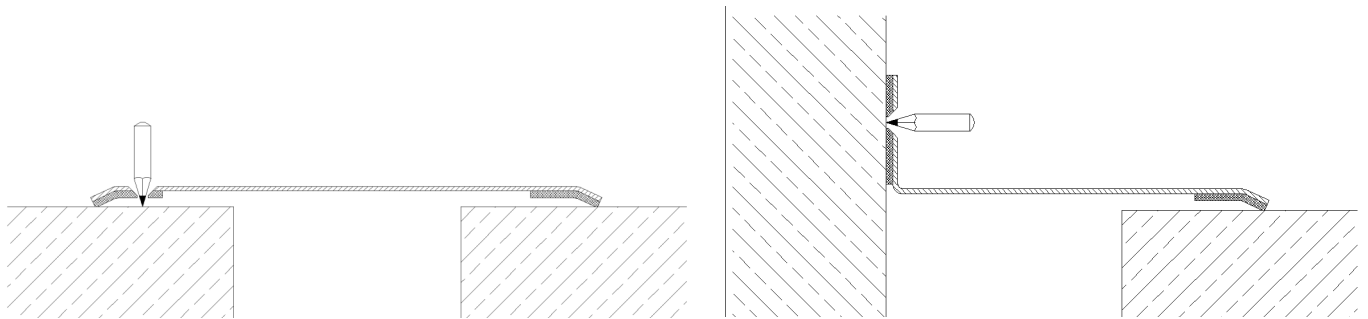

## 5. Drilling the holes

Select a suitable fastener depending on the existing wall material and drill the holes according to the manufacturer's instructions.

## 6. Screwing on the joint cover

If dowels are used, insert them into the holes and position the joint cover with the holes in relation to the holes in the wall. Screw the cover on tightly.

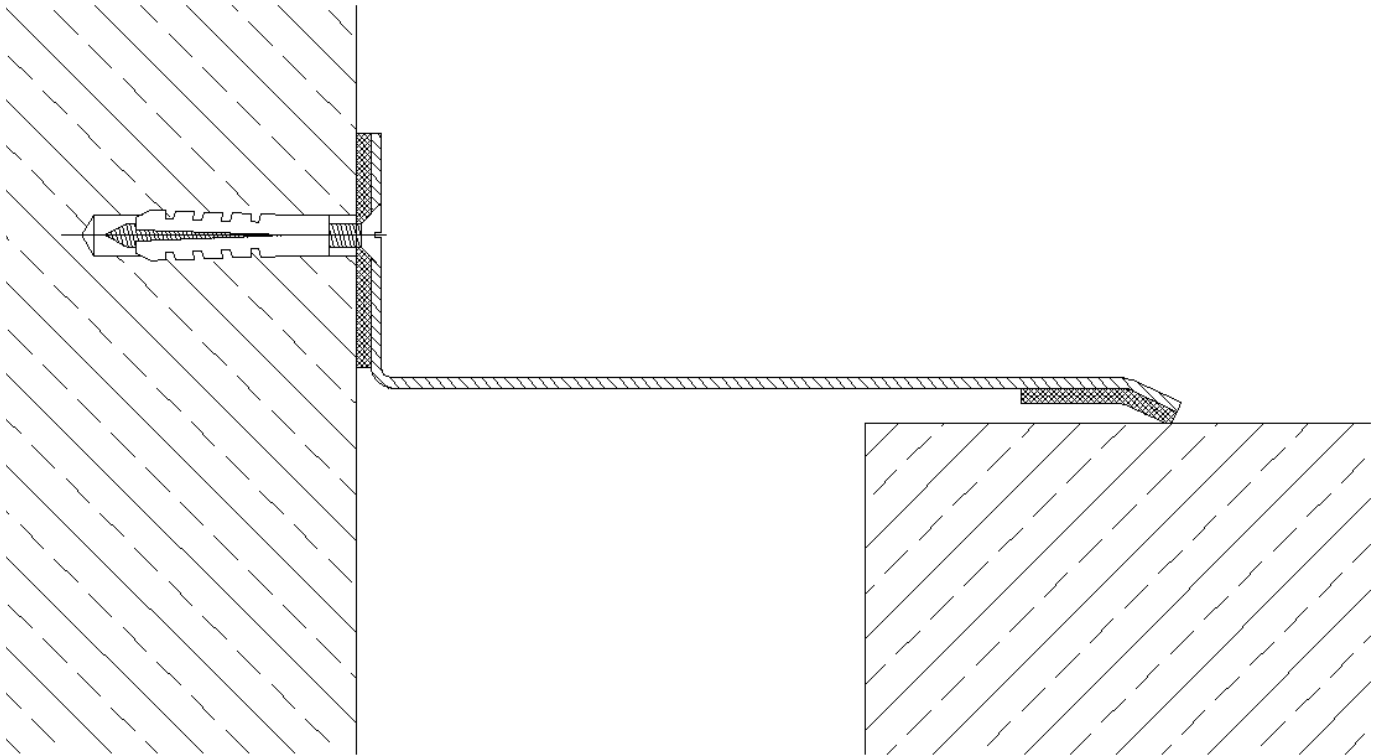
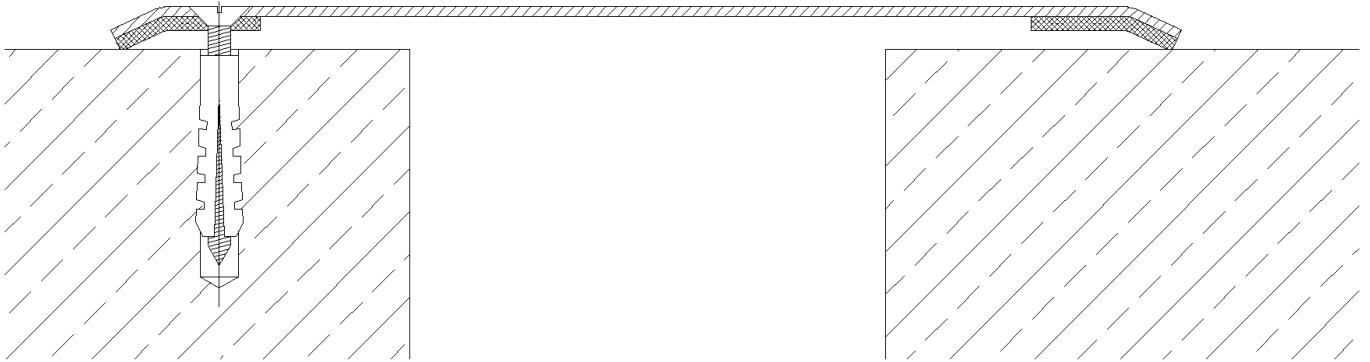

For more information, see: [www.migua.com](http://www.migua.com)

As of: 05/2021