

ASSEMBLY SEQUENCE LONG AAS SHEET JOINT COVERS WITH THE EXAMPLE OF FP 90/45 NI LS

- 1 Cleaning and priming of the installation recess.



- 2 Application of a levelling layer with a pressure-resistant, shrinkage-free and waterproof mortar.



- 3 Cleaning, degreasing and priming of the aluminium brackets and height-adjusted levelling of the joint cover into the still fresh compensation layer (**upper edge of joint cover head is at the upper edge of the finished floor**).

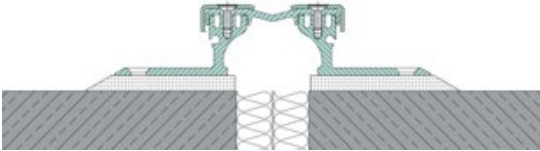

- 4 After curing of the compensation layer, dowel the perforated positioning brackets on both sides (as far out as possible) with compound anchors or screw anchors (distance 350 mm).

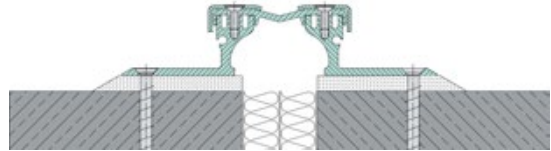

- 5 Cutting of the spacers. Before mounting the centre seal and long AAS sheets, the round cords and plugs must be removed!

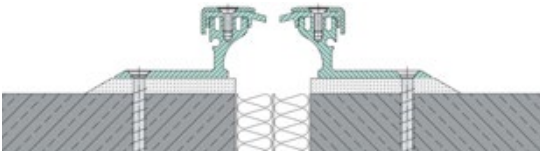

- 6 Press in the long AAS sheets and the middle seal and compress with the stainless steel cover caps and countersunk screws with nylon seals.

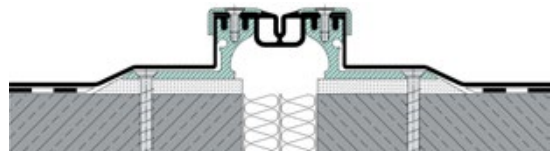

- 7 Embedding of the long AAS sheets into the on-site sealing using the sandwich method with polymer bitumen sealing sheeting and hot adhesive bitumen.

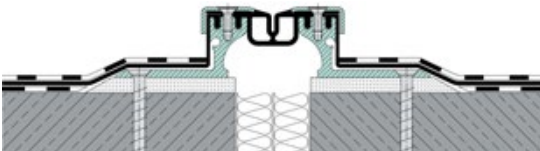

- 8 Production of a filling chamber with suitable filling material.

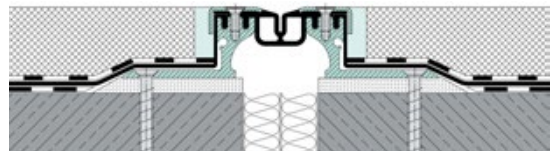

- 9 After approx. 14 days, retighten all fixing screws of the stainless steel cover caps with a torque wrench (7 NM).