

ASSEMBLY SEQUENCE COATED AAS SHEET JOINT COVERS USING THE EXAMPLE OF THE FP 90/25 NI XA

- 1 Cleaning and priming of the installation recess.

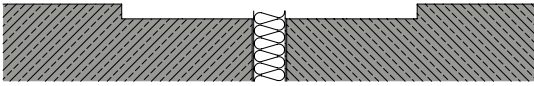

- 2 Application of a levelling layer with a pressure-resistant and shrinkage-free mortar in a water-impermeable mixture.

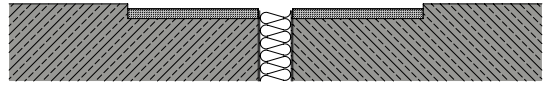

- 3 Cleaning, degreasing and priming of the aluminium brackets and height-adjusted levelling of the joint cover into the still fresh compensation layer (**upper edge of joint cover head is at the upper edge of the finished floor**).

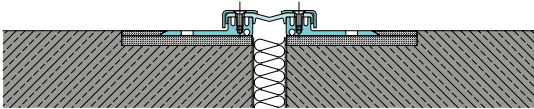

- 4 After curing of the compensation layer, dowel the perforated positioning brackets on both sides (as far out as possible) with compound anchors or screw anchors (distance 350 mm).

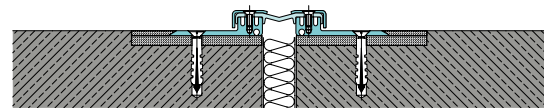

- 5 Cutting of the spacers. Before mounting the centre seal and coated AAS sheets, the round cords and plugs must be removed!

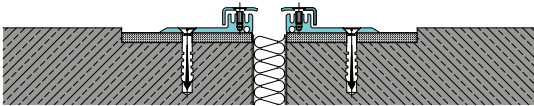

- 6 Press in the coated AAS sheets and the middle seal and compress with the stainless steel cover caps and countersunk screws with nylon seals. Incorporation of the coated sheets into the sealing in the sandwich.

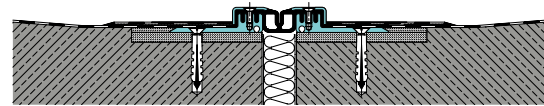

- 7 Installation of the adjacent covering. A filling chamber on both sides with suitable sealant must be made between the covering and the joint cover.

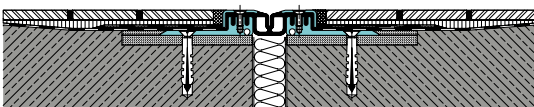

- 8 After approx. 14 days, retighten all fixing screws of the stainless steel cover caps with a torque wrench (7 NM).

