

ST4010 / 4" SAND TRAP LOUVER

SAND TRAP LOUVERS

MIGUSHIELD

ARCHITECTURAL LOUVERS



Architectural Louvers	ST4010 / 4" Sand Trap Louver
Louver Type	Mullion or Continuous Line
Louver Depth	4"
Blade Angle	0°
Free Area	27%
Pressure Drop @900 fpm	0.23

System Description

Extruded aluminum construction; frame with channel profile; corner joints mitered and mechanically fastened, with continuous recessed channel each side.

Material

Head, sill and mullion to be fabricated from 6063-T66 extrusion alloy. Head, sill, jamb, and mullions will be 0.079" (2.00 mm) thick, blades will be 0.079" (2.00 mm). Mechanical fixing using stainless steel or aluminum fasteners.

Structural Design

Structural supports shall be designed and furnished by the louver manufacturer to carry a wind load of not less than 20 psf. (kPa). (Note: If this paragraph is omitted or if the design wind load is not specified, the louvers will be manufactured in self-supporting units up to a maximum of 2000 mm wide by 2000 mm high. Any additional structural supports required to adequately secure these units within the opening shall be the responsibility of others.)

VERTICAL SECTION

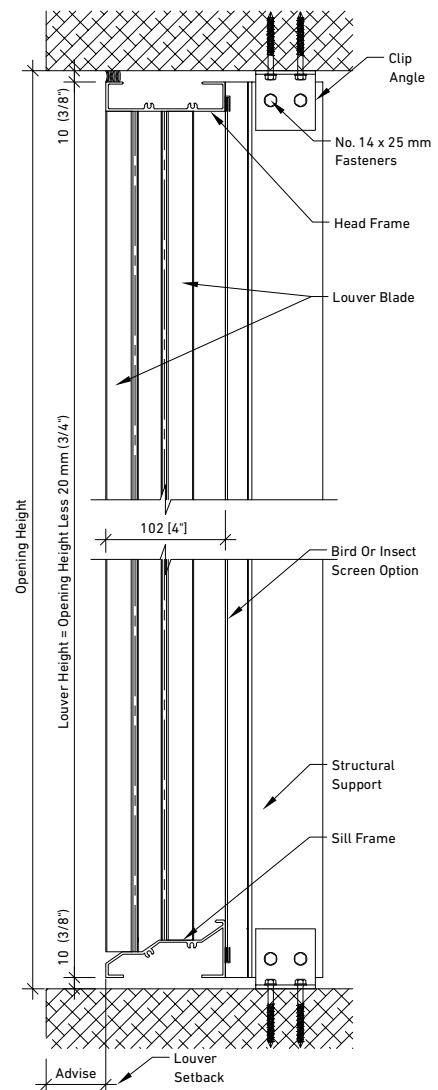

HORIZONTAL SECTION

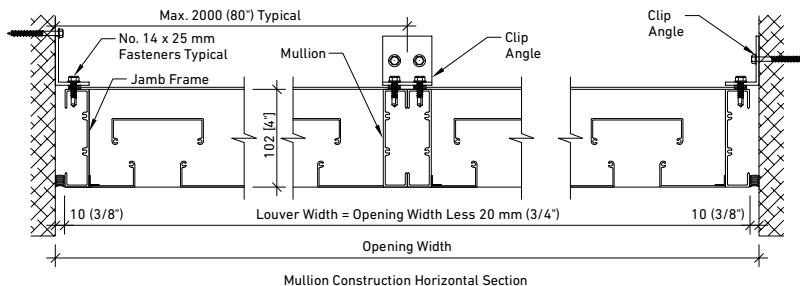

ST4010 / 4" SAND TRAP LOUVER

SAND TRAP LOUVERS

MIGUSHIELD

ARCHITECTURAL LOUVERS

Airflow Performance

Free Area: 27 %

Static Pressure Loss: Not more than (50 Pa) @ (2.6 m/s) Free Area Velocity

Sand Rejection Performance

Sand Rejection Efficiency % @ Core Velocity (M/S)				
Sand Grade	C	D	D	D
1 - 699 Microns (Standard)	80	60	48	22
Free Area Velocity (M/S)	1	2.5	4	5.5

Finishes

- PE-SDF
- PVDF
- Anodize after fabrication

Options & Accessories

- Bird Screen
- Insect Mesh

Installation hardware is not provided unless indicated otherwise by MIGUA. Options and accessories including, but not limited to screens, filter racks, louver doors and blank off panels are not subject to structural analysis unless indicated otherwise by MIGUA.

Louver height in inches/millimeters	Louver width in inches/millimeters													
	12 300	18 450	24 600	30 750	36 900	42 1050	48 1200	54 1350	60 1500	66 1650	72 1800	78 1950	80 2000	
	Free area in square ft/square meters													
12 300	0.11 0.01	0.19 0.02	0.28 0.03	0.36 0.03	0.44 0.04	0.52 0.05	0.60 0.06	0.68 0.06	0.76 0.07	0.84 0.08	0.92 0.09	1.00 0.09	1.03 0.10	
18 450	0.23 0.02	0.39 0.04	0.55 0.05	0.71 0.07	0.87 0.08	1.03 0.10	1.20 0.11	1.36 0.13	1.52 0.14	1.68 0.16	1.84 0.17	2.00 0.19	2.06 0.19	
24 600	0.34 0.03	0.58 0.05	0.83 0.08	1.07 0.10	1.31 0.12	1.55 0.14	1.79 0.17	2.04 0.19	2.28 0.21	2.52 0.23	2.76 0.26	3.00 0.28	3.09 0.29	
30 750	0.45 0.04	0.78 0.07	1.10 0.10	1.42 0.13	1.75 0.16	2.07 0.19	2.39 0.22	2.71 0.25	3.04 0.28	3.36 0.31	3.68 0.34	4.01 0.37	4.11 0.38	
36 900	0.57 0.05	0.97 0.09	1.38 0.13	1.78 0.17	2.18 0.20	2.59 0.24	2.99 0.28	3.39 0.32	3.80 0.35	4.20 0.39	4.60 0.43	5.01 0.47	5.14 0.48	
42 1050	0.68 0.06	1.17 0.11	1.65 0.15	2.13 0.20	2.62 0.24	3.10 0.29	3.59 0.33	4.07 0.38	4.56 0.42	5.04 0.47	5.53 0.51	6.01 0.56	6.17 0.57	
48 1200	0.79 0.07	1.36 0.13	1.93 0.18	2.49 0.23	3.06 0.28	3.62 0.34	4.19 0.39	4.75 0.44	5.32 0.49	5.88 0.55	6.45 0.60	7.01 0.65	7.20 0.67	
54 1350	0.91 0.08	1.55 0.14	2.20 0.20	2.85 0.26	3.49 0.32	4.14 0.38	4.78 0.44	5.43 0.50	6.08 0.56	6.72 0.62	7.37 0.68	8.01 0.74	8.23 0.76	
60 1500	1.02 0.09	1.75 0.16	2.48 0.23	3.20 0.30	3.93 0.36	4.65 0.43	5.38 0.50	6.11 0.57	6.83 0.63	7.56 0.70	8.29 0.77	9.01 0.84	9.26 0.86	
66 1650	1.14 0.11	1.94 0.18	2.75 0.26	3.56 0.33	4.36 0.41	5.17 0.48	5.98 0.56	6.79 0.63	7.59 0.71	8.40 0.78	9.21 0.86	10.02 0.93	10.28 0.96	
72 1800	1.25 0.12	2.14 0.20	3.03 0.28	3.91 0.36	4.80 0.45	5.69 0.53	6.58 0.61	7.47 0.69	8.35 0.78	9.24 0.86	10.13 0.94	11.02 1.02	11.31 1.05	
78 1950	1.36 0.13	2.33 0.22	3.30 0.31	4.27 0.40	5.24 0.49	6.21 0.58	7.18 0.67	8.14 0.76	9.11 0.85	10.08 0.94	11.05 1.03	12.02 1.12	12.34 1.15	
80 2000	1.48 0.14	2.53 0.23	3.58 0.33	4.62 0.43	5.67 0.53	6.72 0.62	7.77 0.72	8.82 0.82	9.87 0.92	10.92 1.01	11.97 1.11	13.02 1.21	13.37 1.24	

MIGUA MIDDLE EAST

www.migua.ae – UAE

A subsidiary of MIGUA FUGENSYSTEME GmbH
Wulfraath, Germany

Made in Germany.

YOU FIRST. **MIGUA**[®]